

BubbleBead Filter

Quick Reference Guide

TwinValve Range

Congratulations on the purchase of your BubbleBead Filter which is designed to give you optimal clarity and health in your pond system. The filter is straightforward to use but care is required during the installation procedure for the correct operation of the filter and the best overall results.

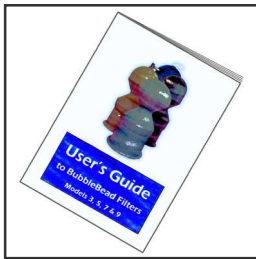

This quick reference guide is not intended to replace your **User's Guide** which carries full details on the installation and operation of your filter. It is important that you refer to this when necessary. In this quick guide the ➤ symbol directs you to the appropriate pages in the full **User's Guide**

Getting Started

This diagram shows the various parts of a typical BubbleBead Filter (TwinValve Range). The exact shape and position of e.g. the outlet checkvalve, will vary between models.

Check that all the necessary parts (➤ page 14) have been received before continuing.

➤ See pages 4 to 7 in your **User's Guide** for a full outline of how the filter system works in normal use.

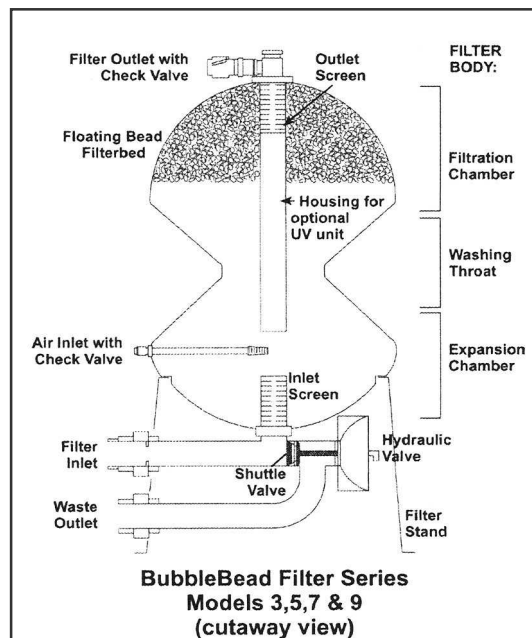

Siting the Filter

➤ see pages 12 to 13 in the User's Guide

DO mount the filter on a firm, level base

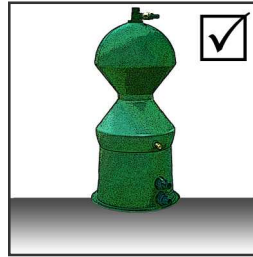

DON'T mount on soft, unstable or unlevelled ground

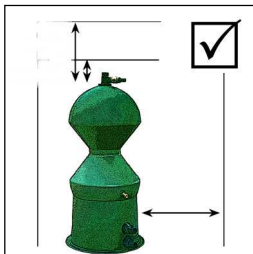
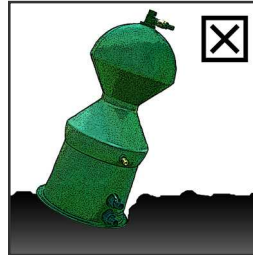

DO leave some access space for maintaining the filter



DON'T fit the filter where future access will be difficult or impossible

DO mount the filter above pond level and above drains/soakaways wherever possible

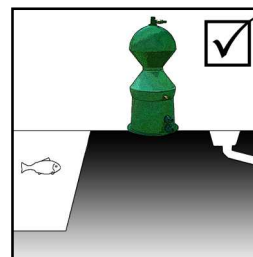

DON'T bury the filter; and don't position in low sites unless unavoidable.

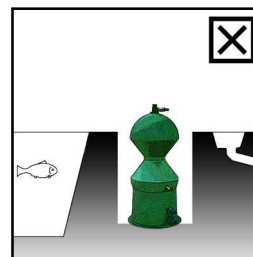

Where low siting is necessary,

- see Appendix 3 in the User's Guide
(Low-Site Valve Assembly & other options)

➤ page 50

- see the section on
Dealing with Waste Water

➤ page 24

Assembling the Filter

➤ The steps to assembling your filter are described on pages 14 to 19 in your User's Guide

DO allow sufficient time and do get assistance to move the filter

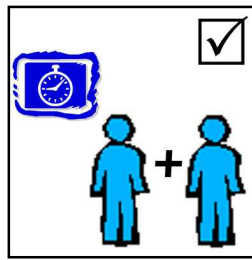

DON'T rush the assembly, or parts could become damaged, and don't attempt to lift heavier items on your own

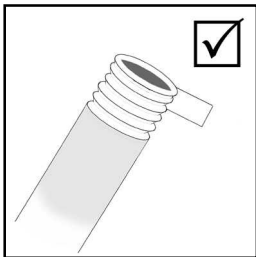

General Plumbing

DO use sufficient PTFE tape on all threads
DO only tighten fittings by hand initially to ensure that the threads are not damaged
DO only tighten further by hand
- or using a soft belt wrench
- or using a tool on the hexagon section

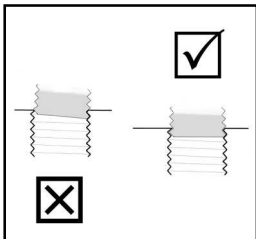

DON'T cross-thread the fittings

DO position the male fittings evenly in the holes, square-on and not at an angle.
Turn anti-clockwise one turn to settle into place before screwing into position.

➤ See plumbing tips on pages 15 & 20-22.

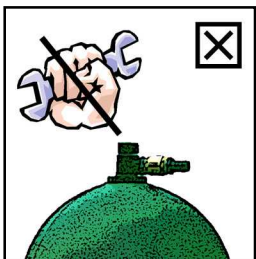

DON'T over-tighten the fittings

DON'T use levers to tighten fittings
- you could crack them!

Inlet and Outlet Plumbing

DON'T use narrow pipes
Avoid knuckle bends

Avoid outlet restrictions (➤ page 52)

DO use large bore hose and pipe
e.g. 1 1/2" hose allows over

two and a half times the flow of 1" hose

DO use swept bends, or double 45° bends in preference to knuckle bends

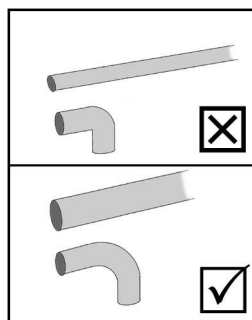

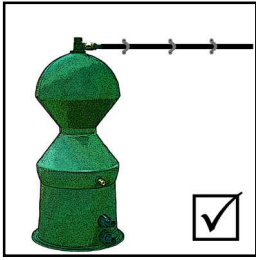

DO support pipework
- use clips to hold pipes in place
against walls etc.

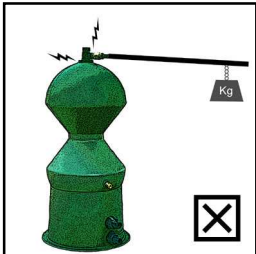

DON'T allow pipework
to put strain on the filter

DO use straight,
large bore pipework
on the waste outlet



DON'T use undulating
or narrow pipes

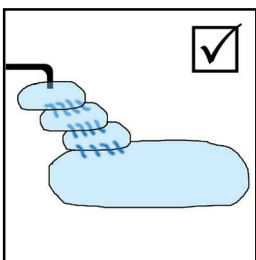
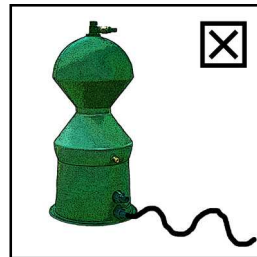

DO encourage aeration
e.g.
- feed return water down cascades
- use an air-pump to feed airstones
in the pond (but keep airstones
away from the filter intake).

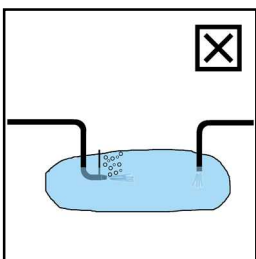

DON'T position return pipes
below water
- this gives poor aeration and
can cause under-pressure in the
filter by siphoning water back
to the pond
➤ page 23

Some venturi return devices tend to restrict flow rates and they are not always a particularly efficient means of aeration. Cascades and air-pumps are recommended alternatives, or use the filter's integral venturi (➤ pages 20, 23 & 44)

Pumps & Strainers (➤ pages 9 - 11)

DO use reliable pumps of appropriate output & pressure, and suited to continuous use

DO use some form of **strainer** (< 2mm gauge) on the pump, or an alternative (page 47) e.g. the EstroSieve unit

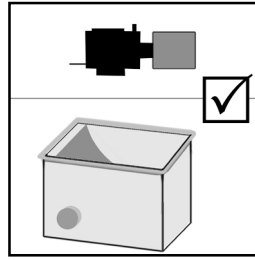

DON'T use solids handling pumps without an additional strainer ➤ page 11

DON'T use high-pressure (over 10m head) pumps without a pressure release bypass ➤ page 52

and DON'T use pumps with a head of over 12m, even if a bypass is fitted ➤ pages 10, 52

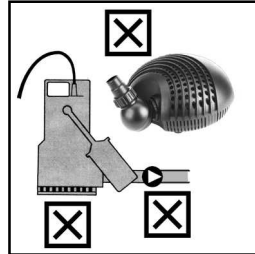

DON'T use additional footvalves on the pump ➤ page 24

Using the Filter

WHEN STARTING FOR THE FIRST TIME:

➤ Follow the Guidelines on page 25 of the User's Guide



DO carry out a **trial backwash**



DO note the time taken for the procedure,
- this gives a guide to how long a typical backwash lasts



DO listen to the backwash operation,
- this gives a guide to how the unit sounds
when operating correctly

RUNNING - IN ➤ pages 26 to 28

All filters take time to mature



DO use filter maturing agents or active media
to seed the filter



DO monitor water quality
(ammonia; nitrite; nitrate; pH etc.)



DO carry out regular backwashes once the filter has fully
matured ➤ page 29 to 31

Regular backwashing can eliminate most water quality and filter clogging problems before they occur



DON'T backwash during the first few weeks whilst the
filter is maturing, and avoid excessive backwashes during
the rest of the maturing period. ➤ page 29



DON'T overstock ponds during the maturing phase

Automatic Backwashing

Fit a timer to your pump to allow automatic backwashing

DO use a **suitable timer** for the pump rating
➤ page 30 

DO consider fitting an **auto top-up** to your system
➤ page 31 

DO **schedule backwashes** to occur at times
when you can monitor the process ➤ page 32

DO ensure that your sump/drain can cope
with the waste water 

DON'T schedule backwashes during main
feeding/viewing times ➤ pages 29 & 43 

Maintenance

The filter is a low maintenance item

– NO filter is ZERO maintenance !

For safe and proper function carry out maintenance of the
shuttle valve and additional backwashes at least **once per
month** This should only take a few minutes ➤ pages 32



DON'T FORGET to maintain your pump strainer
(or EstroSieve) as well



Winter Running

The cold can chill the water and your fish,
and ice can damage your filter system

➤ see page 34

Monitoring your fish & water quality

Being aware of warning signs stops small problems from
developing in to major ones.



If the fish behave unusually -
DO check the water quality

Troubleshooting



? If the water quality is not correct, check the
Water Quality Troubleshooting Guide ➤ starting on page 38
? If the filter system doesn't appear to be functioning correctly e.g.
- the backwash takes longer than normal, or doesn't start properly
- the filter sounds different during the backwash
check the Filter Troubleshooting Guide ➤ starting on page 41

You could also check the support section on the website:

www.bubblebeadfilters.co.uk

For further details: check your User's Guide; check with your dealer; if you are still having problems
- contact the UK distributor Aquatica International Tel: 020 8669 6643
info@bubblebeadfilters.co.uk

quickguide2.52 for use with User's Guide ver 2.52 A3 reformatted to A4